

The courses down this side as follows—

- 813°W 19 to a Stone
- 178°E 9 to a White oak
- 825°E 6 to a H.O.
- 862°E 2 to a H.O.
- 823°W 37.5 to a H.O.
- 877°E 13 to a H.O.
- 813°W 43 to a H.O.
- 877°W 21 to a Post
- 813°W 9 to a H.O.
- 89°W 48.5 to an Elm

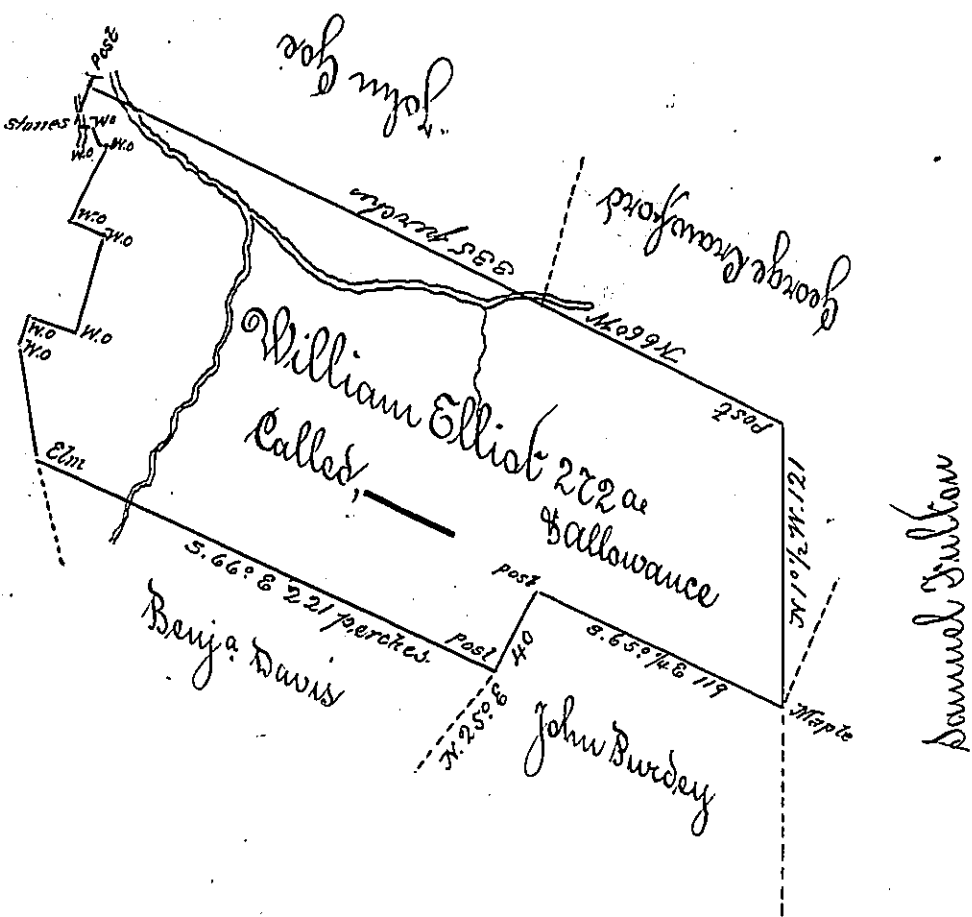

Situated on the Waters of Little Roadstone Creek in Washington Township Fayette County & surveyed the 17th Day of March 1786 in Pursuance of a Warrant dated the 18th Day of November 1785.

To John Lukens Esquire
Surveyor General

P. Alexander No. 1 Clerk Depty

IN TESTIMONY that the above is a copy of the original remaining on file in the Department of Internal Affairs of Pennsylvania, made conformably to an Act of Assembly approved the 16th day of February, 1833, I have hereunto set my Hand and caused the Seal of said Department to be affixed at Harrisburg, this third day of September 1901.

James W. Patta
Secretary of Internal Affairs.